



Georgian Gates

**Unit 2  
Irwell Works  
Lower Woodhill Road  
Bury  
BL8 1AA**

Phone; 0161 763 4145

Fax; 0161 764 4900

e-mail; [info@georgiangates.co.uk](mailto:info@georgiangates.co.uk)



# Automation Information Pack

# **Automation Purchase** **Information**

Thank you for purchasing your automation equipment from Georgian Gates, we hope that you will have many years of trouble free use.

To help make the most of your system please take time to read the following details and store in a safe place for future reference.

Our automation systems are covered by a 2 year guarantee; during this period of time we will cover the cost of all call outs and repairs arising from faulty equipment or faulty workmanship.

Call outs arising from circumstances beyond our control, will be charged the standard rates.

## **Important**

Not included; Items which have been lost, stolen or damaged due to misuse of vandalism and failure of components due to circumstances beyond our control.

Call out charges of £75.00 + vat for the first hour and £35.00 + vat subsequent hours, plus materials will be charged.

Hand held remotes have a 12 month guarantee only.

To order additional key fobs or manual release keys, please send payment to Georgian Gates, including a copy of your name, address and telephone number and we will post them too your.

The programming instructions are detailed on page 5.

<b>Key fobs</b>	<b>£39.95</b>
<b>Manual Release keys</b>	<b>£5.29</b>

(Prices inclusive of VAT @ 17.5%)

## **Important Information;** **Before you call us out**

- ❖ Check if you're remote is operating correctly; do the batteries need to be replaced? (see page 6 for details)
- ❖ Check the electricity supply and fuses are in order
- ❖ Check the photocells; if there is any debris or plant foliage covering the line of the photocells, the gates will not function.

You can manually operate the gates if a problem occurs or if the power supply fails. The motors may have overloaded or 'tripped out' if so, they will continue to work normally after a rest period.

Allow the system to cool down for approximately 1 hour without going in to the range of the gates or other operating equipment (i.e. Electric eyes, loop systems etc...)

If the gates have been reset following a period of manual operation, they will automatically go in to training mode. Press the key fob once and leave for approximately 10 minutes until all operations have ceased.

Please note;

When manually operating the gates, never open them faster than they would operate electrically and make sure that the motors are turned off before doing so.

Please see instructions on page 4 for manually operating the gates, depending on what type of system is in place.

To get advice on any of the above, please contact our office we will be happy to help.

## **General Guidelines for use**

Remember that this equipment can supply a considerable force, which could be a source of danger.

Do not get within the line of the gates whilst they are moving; wait until; they have stopped completely.

Do not allow children within the range of the gates whilst they are moving or to play with the operating controls or radio controls.

Do not apply force against the movement of the gates; this can cause permanent damage to the motors.

To guarantee the continued efficiency of the system, it is recommended that you arrange to have periodic maintenance by qualified personnel.

### **The Maintenance Contract**

For an annual sum, our engineer will visit you at the beginning of the contract year and will undertake a full service and maintenance checks, where any faulty components can be repaired or replaced.

These can be arranged at mutually convenient times.

If you are interested in starting a maintenance contract, please contact our office once the warranty period has expired.

## **Manually operating the gates**

**For in the event of an emergency or power failure**

### **Articulated Motors**

- Insert the key into the access hole
- Turn the key clockwise until it stops; without forcing it
- Fully open the hatch
- Carry out manual operation

To reset;

- Close the hatch
- Turn the key anticlockwise until it stops; without forcing it.
- Remove the key

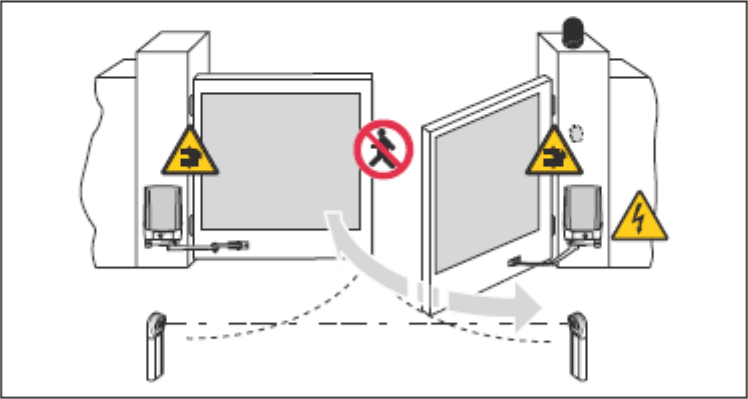
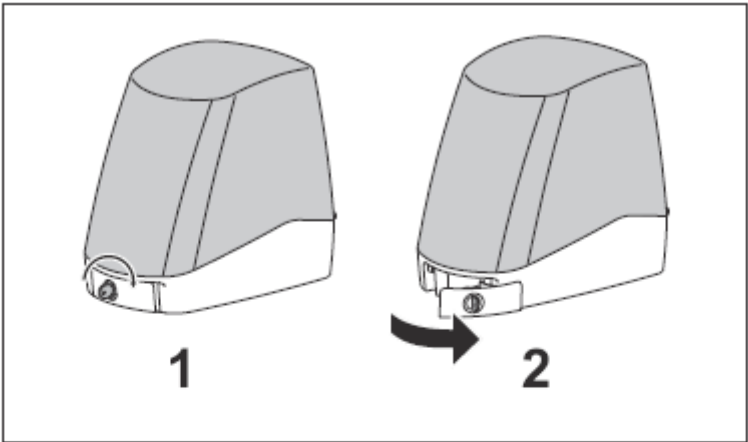

## **Underground Motors**

- Remove the plastic lock cover
- Insert the key into the access hole
- Turn the key 180° clockwise until it stops; without forcing it
- Carry out manual operation

To reset;

- Insert the key in to the access hole.
- Turn the key 180° anticlockwise until it stops; without forcing it.
- Remove the key
- Replace the lock cover

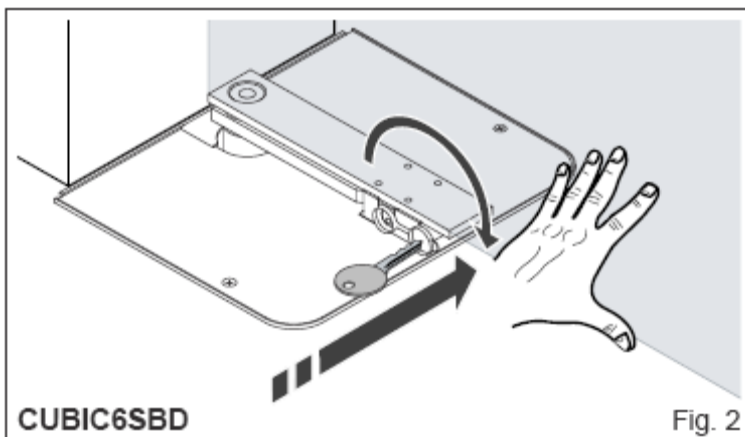
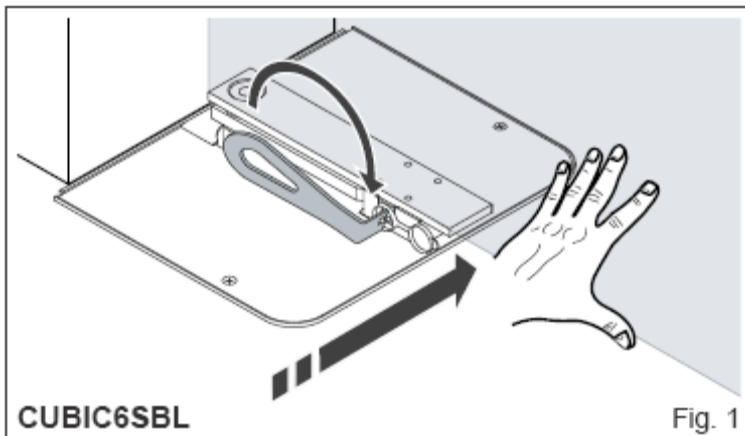

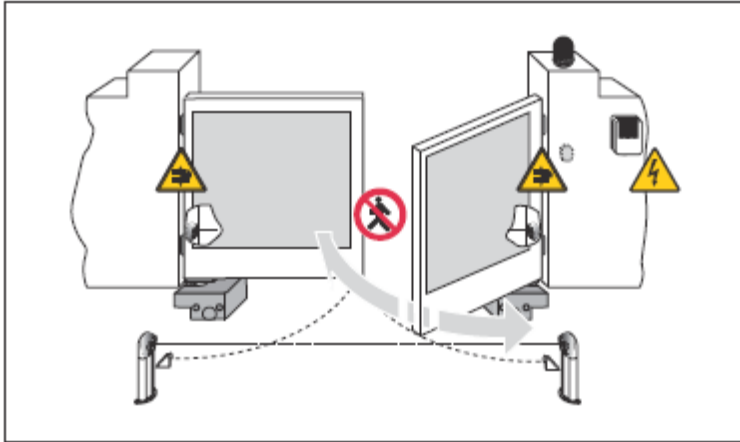

## **Sliding Motor**

- Insert the key into the access hole
- Turn the key anticlockwise until it stops; without forcing it
- Open the release access door 90°
- Carry out manual operation

### **To reset;**

- Insert the key into the access hole
- Close the access release door
- Turn the key clockwise until it stops; without forcing it.
- Remove the key

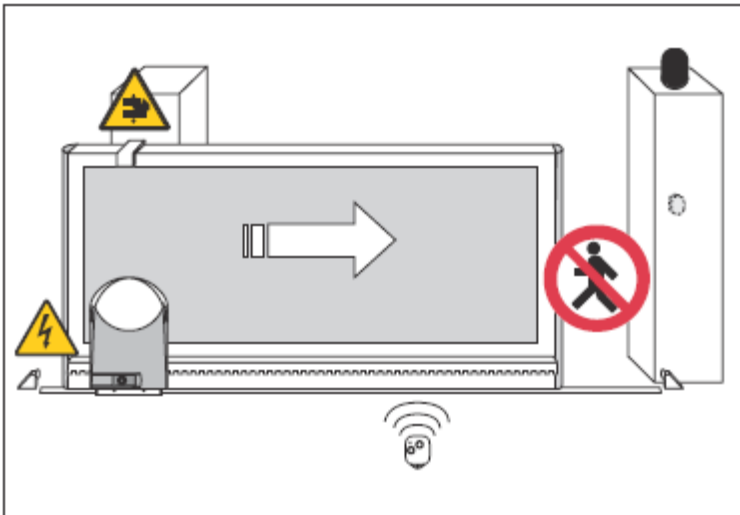
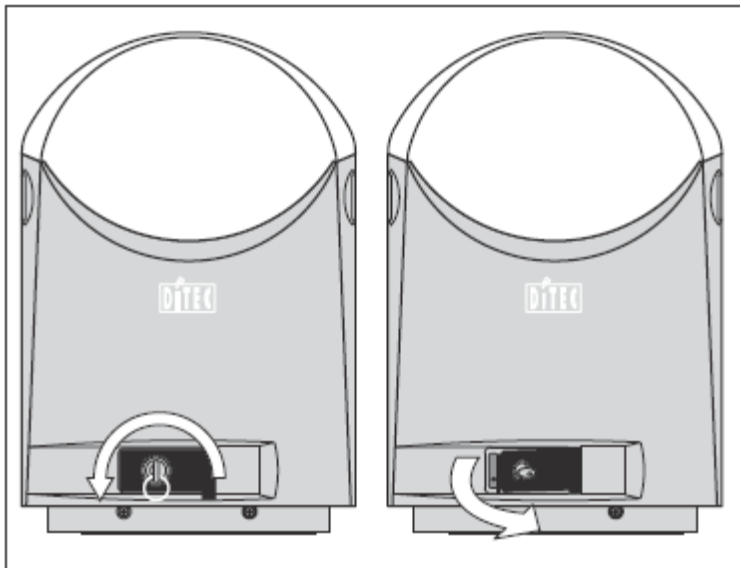

Ditec Sliding Motors

# **Instructions for your new key fob**

Your new key fob will need to be programmed before it can be used.

## **Programming is simple;**

- Insert a pin in to the centre hole on the front of the new key fob.
- Hold for approximately 5 seconds
- Press any of the four buttons on the front of the key fob
- This button will now operate the gates.

Your new key fob will now operate the gates normally

# **Instructions for replacing key fob batteries**

If the red light does not show on your key fob;

- To check if the battery is fitted properly gently shake the key fob, if there is a rattling noise the battery may need adjusting.
- Remove the front cover of the key fob
- Once inside be careful when handling the circuit board.
- Make sure the battery is securely fitted and both positive and negative points are in contact with the battery; if not gently squeeze these contacts back in to place.
- The battery can then be tested by replacing the front cover of the key fob and pressing either of the buttons.
- If the red light shows, the key fob should now be in full working order.
- If no red light shows a replacement battery should be fitted
- Replace the front cover of the key fob making sure that the buttons are in their correct positions

Please note; if any of the components inside the key fob are damaged / broken and are not covered by the warranty.

